



24" ROUND SERIES TRASH RACK FOR CONCRETE RISER (RS-24)



238 McGhee Rd, Winchester, VA. 22603
 phone: (877)-877-5727
 FAX: (540)-722-2219
 www.stormrax.com

RS-24 STANDARD

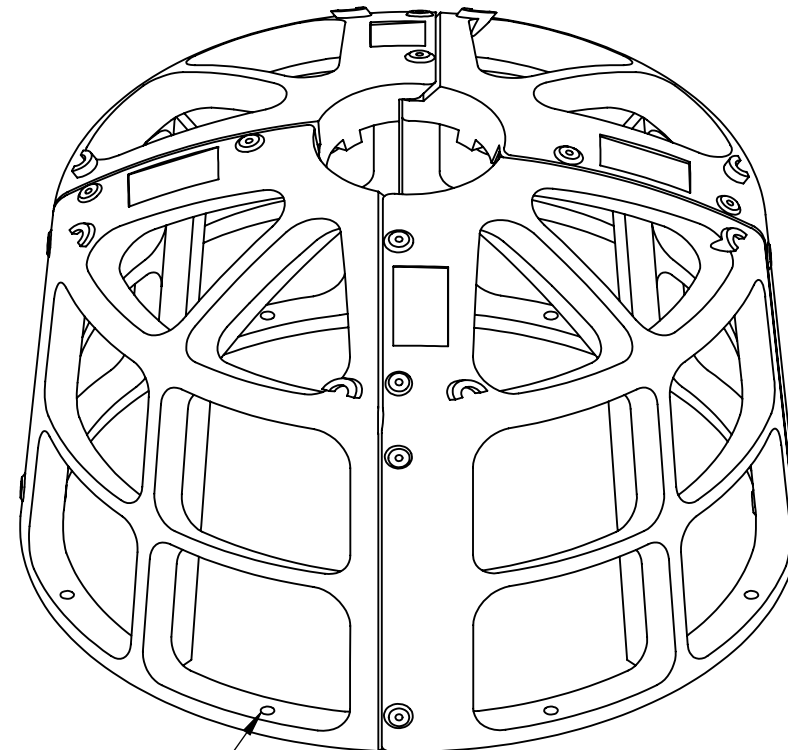

8 EQUALLY SPACED MOUNTING HOLES

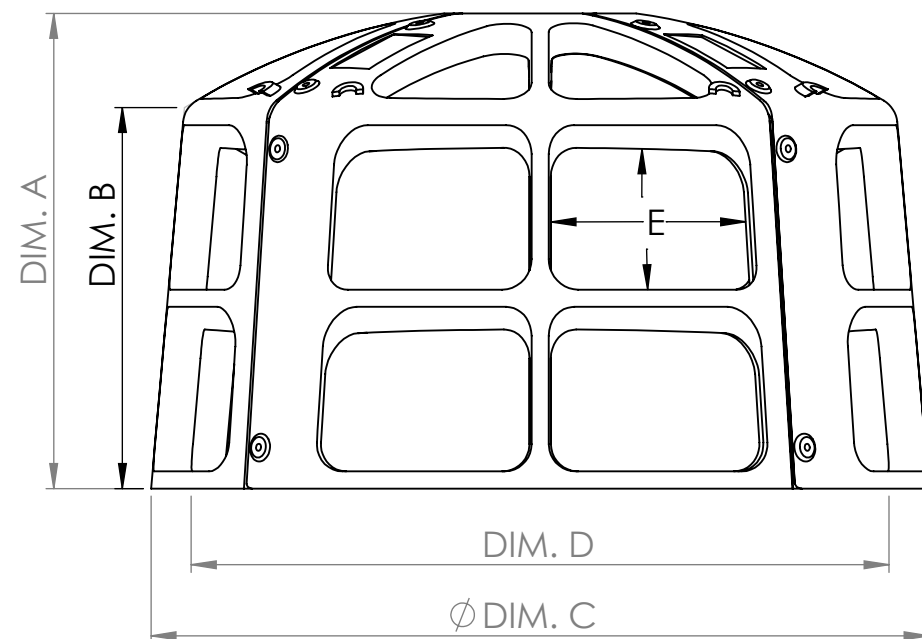

OPTIONAL ANTI VORTEX PLATE

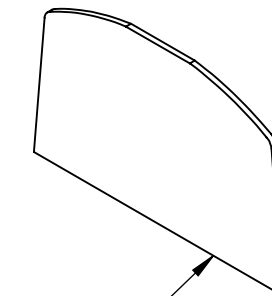
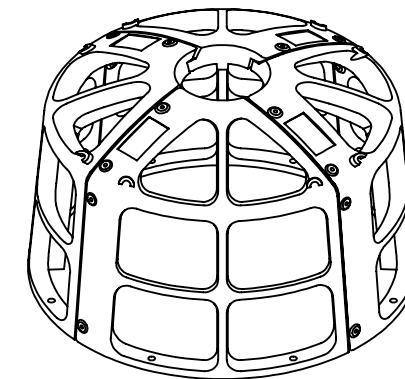

ANTI VORTEX PLATE

PART INFORMATION	
PART NO.	RS-24
DIM. A	17-1/4"
DIM. B	14-1/4"
DIM. C	28"
DIM. D	25-1/4"
DIM E VARIES	4-1/4" X 7" MIN. 7-3/4" X 5-7/8" MAX.
MAX STRUCTURE OD.	30"
MIN. STRUCTURE ID.	24"

PART INFORMATION

NAME: RS-24
 MATERIAL: STRUCTURAL HDPE WITH FIBERGLASS FILL
 WEIGHT: 23 LBS

MOUNTING HARDWARE

ANCHORS: 3/8" X 3" Zinc wedge anchors with nuts and washers (qty.8)

CONSTRUCTION HARDWARE

BOLTS: 1/4" X 7/16" T-bolt (qty. 16)
 NUTS: 1/4"-20 nut (qty. 16)

AVAILABLE OPTIONS

ANTI-VORTEX PLATE

MATERIAL: 1/2" Polyethylene sheet
 ADDED WEIGHT: 5 LBS

ADDITIONAL INFORMATION

Made in USA

DATE: 8/24/2023

DRAWN BY: MM

REV. #1

PROPRIETARY AND CONFIDENTIAL
 THE INFORMATION CONTAINED IN THIS DRAWING IS THE SOLE PROPERTY OF PLASTIC SOLUTIONS, INC. ANY REPRODUCTION IN PART OR AS A WHOLE WITHOUT WRITTEN PERMISSION BY PLASTIC SOLUTIONS, INC. IS PROHIBITED.